

Title:	<b>Shaker FlexerBlock Replacement of Flexures</b>	ID:	
		0016	
Date in:	Response:	Model:	Author:
2007-06-13	2007-06-13	-	CMa

## Replacement Flexures on Flexure Block

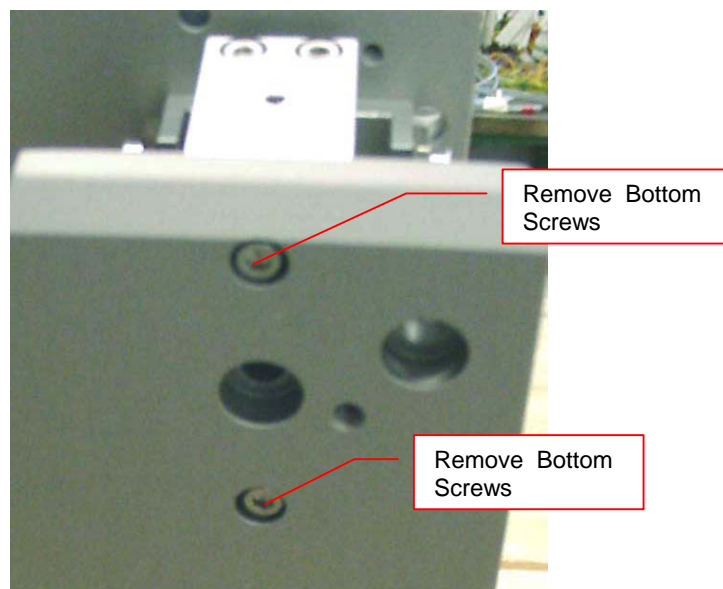

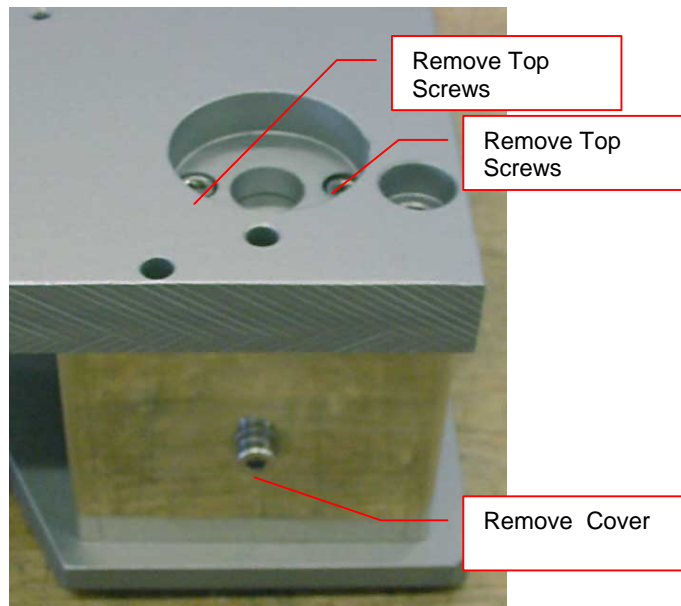
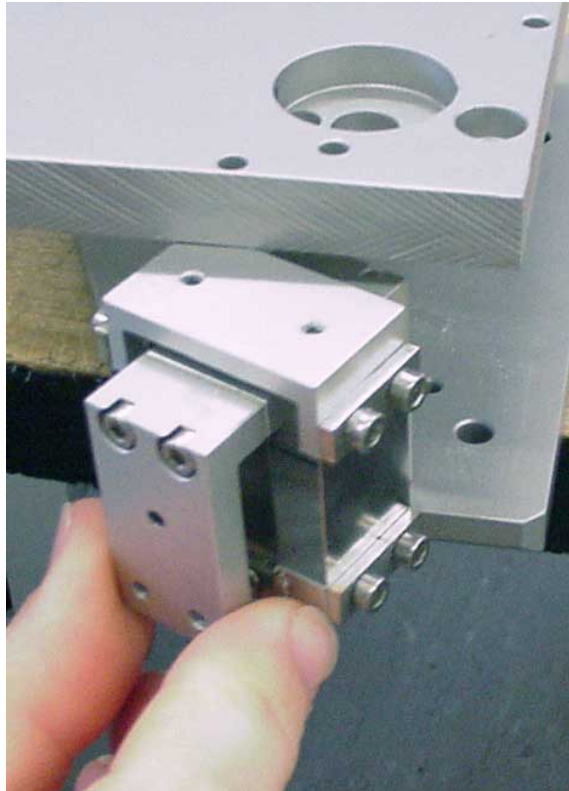

Replace flexures, use flat surface for aligning flexures

Do NOT tighten screws, since final alignment will be done with flexure block installed in place

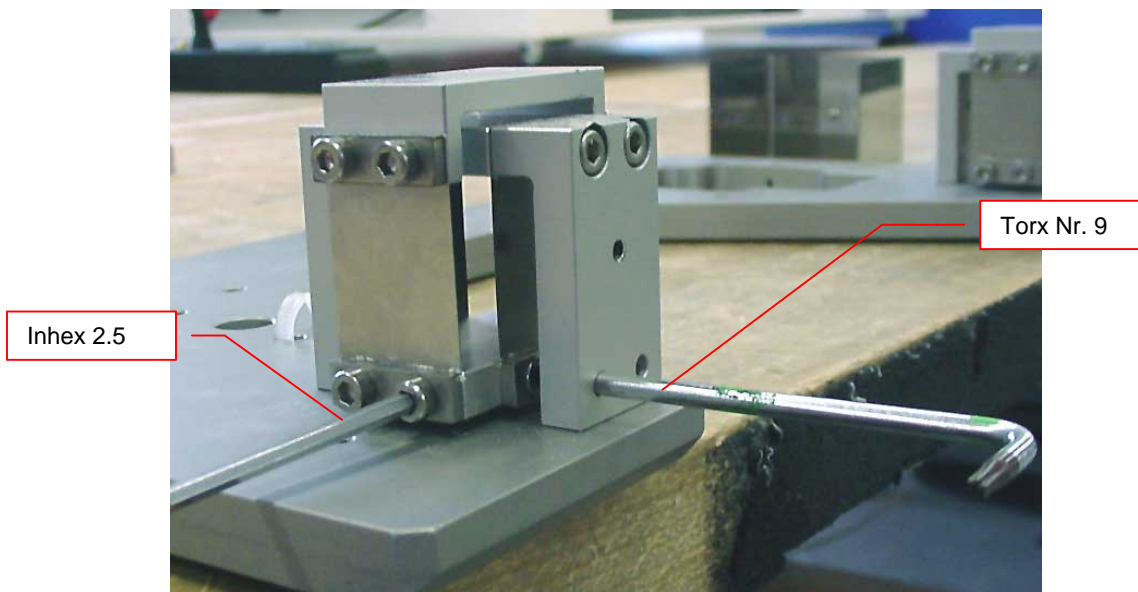

Tighten screws when flexure block is installed. Watch for tension free installation

